	<b>SARA SAE ENGINEERING SPECIFICATION</b>		
	<b>Section: SES 26 – 590</b>		
	<b>Issue: “D”</b>	<b>Rev No: “7”</b>	
	<b>Eff. Date: 17-09-2025</b>	<b>Page: 1 of 6</b>	

**GENERAL REQUIREMENT FOR FORGED OR WROUGHT MATERIALS**  
**PSL 1, 2, 3 & 4**

Rev	Reason of Change	Date	Made By	Reviewed By	Approved By	Status
2	Clause 6.4.5 amended for sacrificial part shall be used as QTC for flanges 8” OD and above	29-10-2012	JG	JMS	KKD	Released
3	Clause 3.0 and 6.4.7 amended and clause 6.3.3 added	15-12-2015	AS	JMS	KKD	Released
4	Clause 3.0 reference API6A 21 <sup>st</sup> Edition, & Clause 6.4.8 amended.	06-07-2019	MN	AS	USR	Released
5	Wrought product is amended to wrought materials in clause 1.0 & 2.0 as per errata 2 of API6A 21 <sup>st</sup> Edition.	04-07-2020	MN	AS	USR	Released
6	Revised to include the requirement of API 6A - Tensile, Impact and Visual Examination Requirements	18-04-2024	FA	USR	JG	Released
7.	Revised as per API 6A & addendum 2 of 16 A	17-06-2025	NK	USR	JG	Released





	<b>SARA SAE ENGINEERING SPECIFICATION</b>	
	<b>Section: SES 26 – 590</b>	
	<b>Issue: “D”</b>	<b>Rev No: “7”</b>
	<b>Eff. Date: 17-09-2025</b>	<b>Page: 2 of 6</b>

## **GENERAL REQUIREMENT FOR FORGED OR WROUGHT MATERIALS PSL 1, 2, 3 & 4**

### **6.1 1.0 PURPOSE**

This document is to define the minimum requirements for processing and certification, for forged or wrought materials.

### **6.2 2.0 SCOPE**

This specification establishes material requirements for forgings or wrought materials for PSL level 1, 2, 3 & 4. It shall be used in conjunction with specific material specifications (MS) or approved vendor supplied material specifications. This specific Material Specification may amend or modify the requirements of this specification.

### **6.3 3.0 REFERENCE**

The latest effective editions of the following specifications are incorporated as reference and form a part of these specifications.

API 6A - Specification for wellhead and Tree Equipment

API 16A- Specification for Drill Through Equipment

API 16C- Choke and kill Equipment

ASTM A-370 or ISO 6892-1 or IS: 1608: 2005 - Standard Test methods and Definitions for Mechanical Testing of Steel products.

ASTM E-10 or ISO 6506- Standard Test Method and Brinell Hardness of Metallic Materials.

ASTM E-18 or ISO 6508- Standard Test Methods for Rockwell Hardness and Rockwell superficial hardness of Metallic Materials.

SES 26-738 Charpy Impact Test requirement

SES 26-740 Specification For General Requirements Of Heat Treatment Of Alloy Steels For Use In Well Head. Christmas Tree, Manifold and Related Equipment

SSE/QAD/VE-93 Visual Examination

### **4.0 RESPONSIBILITY**

The Engineering Manager is responsible for the preparation and controls the material specifications. Quality Control Manager supported by quality management is responsible for the implementation of the material requirements.

### **5.0 DEFINITIONS**

#### **5.1 Heat Treat Lot-**

- A. Batch Furnace-Material Placed on loading or carry devices and moved as a batch through one heat-treat cycle.





	<b>SARA SAE ENGINEERING SPECIFICATION</b>	
	<b>Section: SES 26 – 590</b>	
	<b>Issue: “D”</b>	<b>Rev No: “7”</b>
	<b>Eff. Date: 17-09-2025</b>	<b>Page: 3 of 6</b>

- B. Continuous Furnace-Group of piece of material with the same nominal size that is moved sequentially through the heat treatment process using the same process parameter.

## 6.4 PROCEDURAL REQUIREMENTS

### 6.5 MELTING PRACTICE

- 6.5.1 Steel products shall be made by the electric furnace or basic oxygen furnace process. Additional may be performed by ladle refining, vacuum degassing, vacuum arc remelting (VAR), electro slag remelting (ESR), or argon oxygen decarburization (AOD).
- 6.5.2 Nickel base alloy primary melting method shall be vacuum induction or electric arc furnace with or without argon oxygen decarburization (AOD). Secondary processing shall be electro slag remelting (ESR) or vacuum arc remelting (VAR).

### 6.6 MILL PRACTICE

Product supplied to this specification shall be free from defects which would detrimentally affect serviceability. Such defects include, but are not limited to, cracks, laps, flakes, fissures, slag, porosity, and rolled-in scale.

### 6.7 HOT WORKING PRACTICE

- 6.7.1 The material shall be of pressure vessel quality and shall be formed using a hot Working practice, which produce a wrought structure throughout. Hot working practice shall be documented.
- 6.7.2 Hot working practice shall produce a minimum reduction ratio of 3:1. When requirements dictate a 4:1 or greater reduction ratio, the reduction ratio shall be specified on the applicable part.
- 6.7.3 The QTC hot working ratios that are equal to or less than those used in processing the production part(s) it qualifies. The total hot working ratio for the QTC shall not exceed the total hot working ratio of the part(s) it qualifies.

### 6.8 MATERIAL QUALIFICATION

- 6.8.1 Minimum tensile, and if required, impact properties tests shall be performed on a qualification test coupon (QTC). Test specimens shall be removed from the QTC after the final QTC heat treatment cycle, and shall be from the same melt, or remelt ingot (s) as the production material/ part (s).
- 6.8.2 The properties of the QTC shall represent the properties of the material comprising the production material/part(s) it qualifies. A QTC shall only qualify material/part(s) produced from the same heat. The hot working ratio used on the QTC shall be same or less than that used on production material/part(s).
- 6.8.3 When the QTC is obtained by trepanning or using a sacrificial production. Material/part(s), it may only qualify production material/part(s) having the same or smaller ER as that used to obtain the QTC.

Note: The equivalent Round (ER) of the QTC shall be equal to or exceed that of the material/part(s) being heat-treated. The ER of the material/parts(s) shall be determined using the actual dimensions of the material/part(s) in the as heat-treated condition per

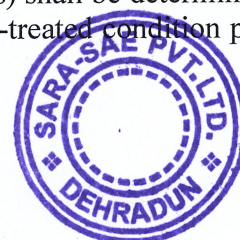



	<b>SARA SAE ENGINEERING SPECIFICATION</b>	
	<b>Section: SES 26 – 590</b>	
	<b>Issue: “D”</b>	<b>Rev No: “7”</b>
	<b>Eff. Date: 17-09-2025</b>	<b>Page: 4 of 6</b>

the calculation method specified in FIG 1. The QTC shall be a minimum of 7" long for a standard specimen. The maximum ER required shall be 5" (4" x 4" QTC) unless otherwise specified by the specific part requirements. Tensile specimens shall be removed from the QTC such that their longitudinal centerline axis is wholly within the center core 1/4 T envelopes for a solid QTC or within 1/8 inch of the mid-thickness of the thickest section of a hollow QTC (refer to FIG 1). The impact specimens shall be removed such that the notch is within the 1/4 T envelopes.

For QTCs larger than the ER or greater than 4" x 4", the test specimens need not be removed from a location farther from the QTC surface than would be required if the specified QTC were used.

- 6.8.4 Test specimens shall be removed from the QTC such that the tensile specimen gauge length and Charpy V-Notch root are the least 1/4 T from the ends of the QTC. For Charpy Impact Requirement refer SES 26-738.
- 6.8.5 When sacrificial production material/part(s) is used as a QTC, the test specimens shall be removed from a section of the part meeting the size requirement for a QTC for that production part. For all flanges of diameter 8" and above sacrificial part shall be used as QTC.
- 6.8.6 Tensile test shall be conducted per the procedures of ASTM A-370 or ISO 6892-1 or IS 1608:2005 Tensile test shall be performed at room temperature between 4 °C and 50 °C (between 40 °F and 120 °F) unless an elevated temperature is specified. Standard size 0.505 Inch diameter tensile specimen or a sub size 0.252-inch diameter specimen as referred in ASTM-370 shall only be used. A minimum of one test shall be performed. The results shall satisfy the applicable specific Material Specification. If the results of the tensile test are not satisfactory, two additional tensile tests may be performed. The result of each of these tests shall satisfy the applicable requirements.
- 6.8.7 The heat treated QTC shall be checked for hardness per ASTM-E-10 or E-18 or ISO 6506 or ISO 6508 as applicable per spec requirement. A minimum of one hardness test shall be performed on the QTC. For API 16A products hardness testing shall be performed in accordance with ISO 6892 or ISO 6506-1 as appropriate.
- 6.8.8 For material heat treated in a continuous furnace, the QTC shall consist of a sacrificial production part or a prolongation removed from production part. The sacrificial production part or prolongation QTC shall qualify only production parts having and identical shape and size. The QTC shall qualify only materials and parts produced from the same heat and heat treat lot. For continuous furnaces, a heat treat lot is defined as a group of pieces of material with the same nominal size that is run through the furnace sequentially at the same zone temperatures, travel speed, and other parameters.

A minimum of one QTC shall be provided for each of material. Tensile and impact tests shall be conducted on the QTC in accordance with paragraphs 5.2 through 5.7. A hardness traverse shall be conducted on a cross-section from QTC, with Brinell hardness readings taken at the surface, the 1/4 diameter location, and the center of the

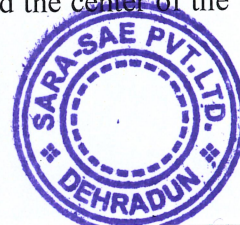



	<b>SARA SAE ENGINEERING SPECIFICATION</b>	
	<b>Section: SES 26 – 590</b>	
	<b>Issue: “D”</b>	<b>Rev No: “7”</b>
	<b>Eff. Date: 17-09-2025</b>	<b>Page: 5 of 6</b>

bar. In addition to the testing required on the QTC, each bar shall be individually hardness checked. Brinell hardness measurements shall be taken on the surface at two or more locations.

## 6.9 HEAT TREATMENT

- 6.9.1 Material/part(s) and QTC shall be heat treated per the process cycle listed in the specific Material Spec. Equipment used for heat treatment shall have a temperature uniformity of  $\pm 25^{\circ}\text{F}$  or  $14^{\circ}\text{C}$  ( $\pm 15^{\circ}\text{F}$  OR  $8^{\circ}\text{C}$  for tempering furnaces) inside the heating chamber. Material/part(s) shall be loaded in the furnace such that the heat treat response of all material /part(S) will be uniform.
- 6.9.2 The quenching media and agitation should be of sufficient capacity for the furnace load.
- 6.9.3 Material/part (s) shall be traceable to and marked with the heat treat lot (heat treat batch) identification.
- 6.9.4 When the QTC is not heat treated as part of the same heat treatment lot as the material/part(s) it qualifies, the Austenizing (Or solutionizing) temperature for the QTC shall be within  $25^{\circ}\text{F}$  ( $14^{\circ}\text{C}$ ) of those for the material/part(s). The tempering temperature of the material/part(s) shall not be lower than  $25^{\circ}\text{F}$  ( $14^{\circ}\text{C}$ ) below that of the QTC. The upper limit shall be no higher than that permitted by the specific MS. The cycle time at each temperature shall not exceed that for the material/part (s).

## 6.10 INSPECTION

Material shall be inspected for injurious imperfections as listed in the following:

- 6.10.1 Material provided in the rough machined condition shall not exceed 250 AA In surface roughnesses in the machined areas, and shall be free of burrs or injurious imperfections
- 6.10.2 Material shall have workmanlike finish and shall be free of internal forging burst or hydrogen flakes.
- 6.10.3 Surface imperfections such as laps, seams folds tear silver or mechanical marks, abrasion or pits need not be removed unless they infringe on the minimum wall thickness of the material or extend to a depth greater than 1/6 inch.
- 6.10.4 The ER of QTC shall be equal to or greater than the ER of the part it qualifies at the critical thickness as defined, except the QTC is not required to exceed 254 mm (10 in.) ER. The ER of the part shall be calculated based on the dimensions at the time of heat treatment.

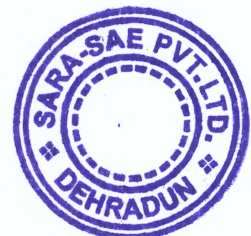



	<b>SARA SAE ENGINEERING SPECIFICATION</b>	
	<b>Section: SES 26 – 590</b>	
	<b>Issue: “D”</b>	<b>Rev No: “7”</b>
	<b>Eff. Date: 17-09-2025</b>	<b>Page: 6 of 6</b>

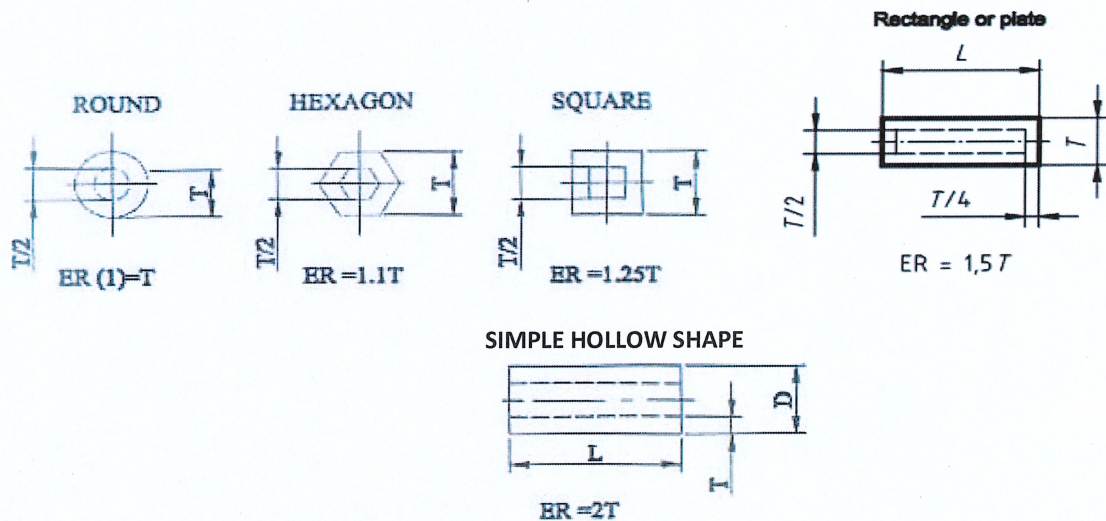

**a) SIMPLE GEOMETRIC EQUIVALENT ROUND SECTIONS/SHAPES HAVING LENGTH L**

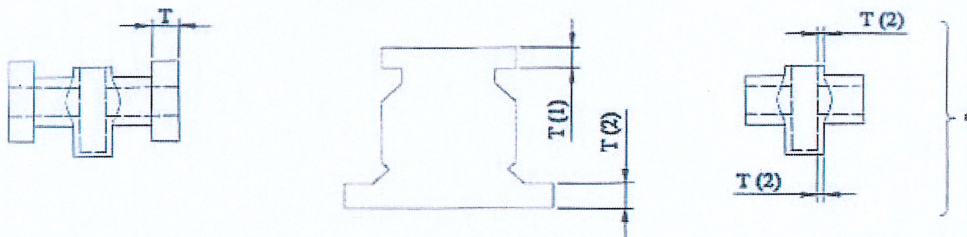

**b) GENERAL, FLANGED BODIES FOR COMPLEX-SHAPED WELLHEAD COMPONENTS**

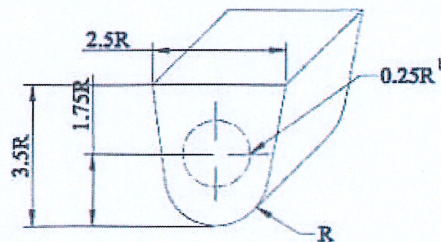

**c) KEEL BLOCK CONFIGURATION, ER=2,3R**

- When L is less than T, consider section as a plate of thickness area inside of dashed lines is 1/4T envelope for test specimen removal. (as per API 16A 5.3.5.2.3 & 6A 6.4.2.3.2)
- When L is less than D, consider as a plate of T thickness. (as per API 16A 5.3.5.2.3 & 6A 6.4.2.3.2)
- On multi flanged components, T shall be the thickness of the thickest flange. (as per API 16A 5.3.5.2.3 & 6A 6.4.2.3.2)
- Where T is the thickness when the component is heat treated as in T (2), use the larger of the two indicated dimensions. (as per 6A 6.4.2.3.2)

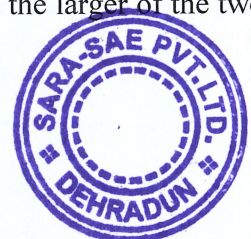



	<b>SARA SAE ENGINEERING SPECIFICATION</b>	
	<b>Section: SES 26 – 590</b>	
	<b>Issue: “D”</b>	<b>Rev No: “7”</b>
	<b>Eff. Date: 17-09-2025</b>	<b>Page: 7 of 6</b>

- e) Bodies with screwed and open ends.
- f) Envelope for test specimen removal

NOTE: When all internal and external surfaces during heat treatment are within 13mm (1/2 in) Of the final surfaces, ER=1-1/4T when all internal and external surfaces during heat treatment are not with in 13mm (1/2 in) of the final surface, then ER=2T.

## 6.11 VISUAL EXAMINATION

- 6.11.1 Sampling to be performed in accordance with ISO 2859-1:1999, level II, 2.5 AQL for O-rings and 1.5 AQL for other seals.
- 6.11.2 Each piece of the sample to be visually inspected according to Procedure for Visual Examination of steel castings / Forgings / Wrought Material and Welded Joints (SSE/QAD/VE-93).
- 6.11.3 If inspection methods produce rejections less than allowed in sampling, the batch will be accepted.

